

UNIT LINKS - TAGS AND SCHEDULES BASICS

UNIT X mX

Name
XXXX

Tag_Unit Room.rfa
 ☆☆☆☆☆
 Libraries: ORB REVIT SYSTEM SYMBOLS
 Tags: --
 Reviews: 0 Loads: 0 Downloads: 0
 Revit Category: RVT Link Tags
 Revit Version(s): 2023

✗ ONLY UNITS OF NAME HIGHER THAN 10 WILL BE COUNTED ON THE UNIT MATRIX - MAKE SURE ALL YOUR LINKS FOR THE UNIT ENLARGED DRAWINGS ARE NAMED " ENLARGED UNIT (UNIT TYPE)"

BUILDING UNIT LINKS SHOULD ALWAYS BE IN THE " BUILDING UNIT LINKS" WORKSET
 ENLARGED UNIT LINKS SHOULD ALWAYS BE IN THE " UNIT ENLARGED PLANS" WORKSET

✗ THE M FOR THE MOD WILL NOT APPEAR UNTIL A NUMBER IS ADDED IN THIS FIELD. DON'T ADD AN "m" TO YOUR MOD FIELD.

THIS APPLIES WHEN A MOD IS A DESIGN OPTION INSIDE OF THE UNIT LINK. OTHERWISE SET THE "RVT_UNIT_TYPE PARAMETER" TO HAVE THE MOD NAME, WHEN THE DESIGN OPTION HAS A UNIQUE LINK.

Properties

Linked Revit Model
19220_Unit A1_cqkRN4EV.rvt

RVT Links (1) Edit Type

Identity Data

Image

Comments

Name 328

Mark 33

Workset Workset1

Edited by cqkRN4EV

IFC Parameters

Export to IFC By Type

Export to IFC As

IFC Predefined Type

IfcGUID 2PDhbCpKj758B7nIW...

Data

RVT_Unit Bldg No. TEST 1

RVT_Unit Level LEVEL 1

RVT_Unit Mod

Other

Shared Site <Not Shared>

Properties help Apply

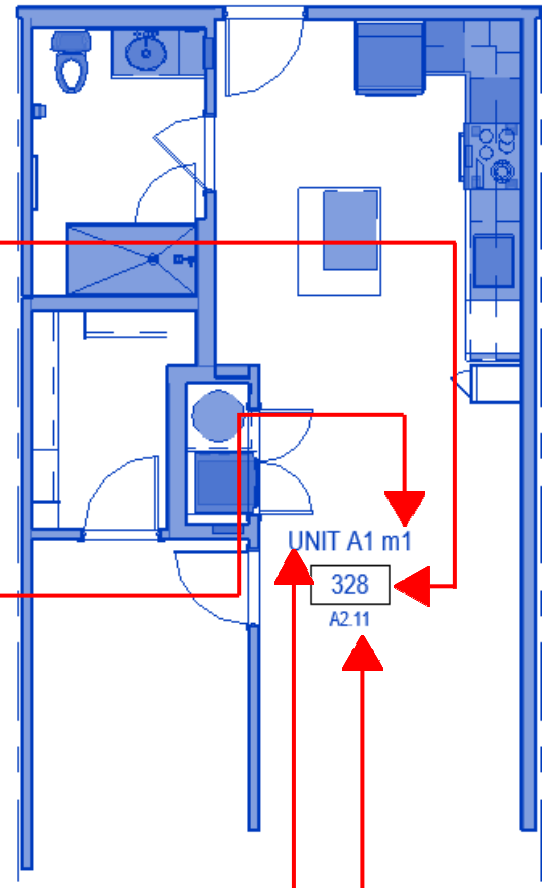

Type Properties

Family: System Family: Linked Revit Model Load...

Type: 19220_Unit A1_cqkRN4EV.rvt Duplicate... Rename...

Type Parameters

Parameter	Value
Description	
Assembly Description	
Assembly Code	
Type Mark	
Cost	
Workset	Workset1
Edited by	
IFC Parameters	
Export Type to IFC	Default
Export Type to IFC As	
Type IFC Predefined Type	
Type IfcGUID	2PDhbCpKj758B7nIWMOYhM
Data	
RVT_Unit Type	UNIT A1
RVT_Unit Order	1
RVT_Unit No. Bedrooms	1 BEDROOMS
RVT_Unit Count	1.000000
RVT_Unit Placed on Sheet #	A2.11
Other	
Reference Type	Overlay
Phase Mapping	Edit...

What do these properties do?

<< Preview OK Cancel Apply

✗ VALUES FOR THIS PARAMETER

STUDIO	- 0
1 BEDROOM	- 1
2 BEDROOM	- 2
3 BEDROOM	- 3

THIS ITEM CONTROLS THE ORDER THE UNITS GET LISTED IN YOUR UNIT MATRIX

ALWAYS SET TO 1

ALWAYS SET TO ATTACHED